



3/26-28 Gibbs Street Miranda NSW

PRICE REDUCED TO SELL

Located within a prestigious Medical Centre building on a picturesque tree-lined street, this ground floor suite offers an ideal setting for medical professionals. Perfectly positioned adjacent to Miranda Train Station and just a short stroll from Westfield Miranda, this suite is ready for immediate occupancy.

Key features include:

- ? 61sqm of medical suite space with a patio on the ground level
- ? Reception area, 2 office spaces, and a storeroom
- ? Private kitchenette/lunchroom
- ? Allocated secure basement parking spaces

[For full version visit the website](https://www.singerresidential.com.au/8041131)

Type	: Offices
Price	: \$450,000 - \$480,000
Building Size	: 61 sqm
View	: https://www.singerresidential.com.au/8041131



Joshua Singer
02 9528 8738

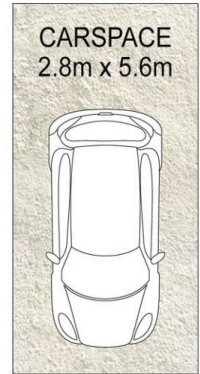
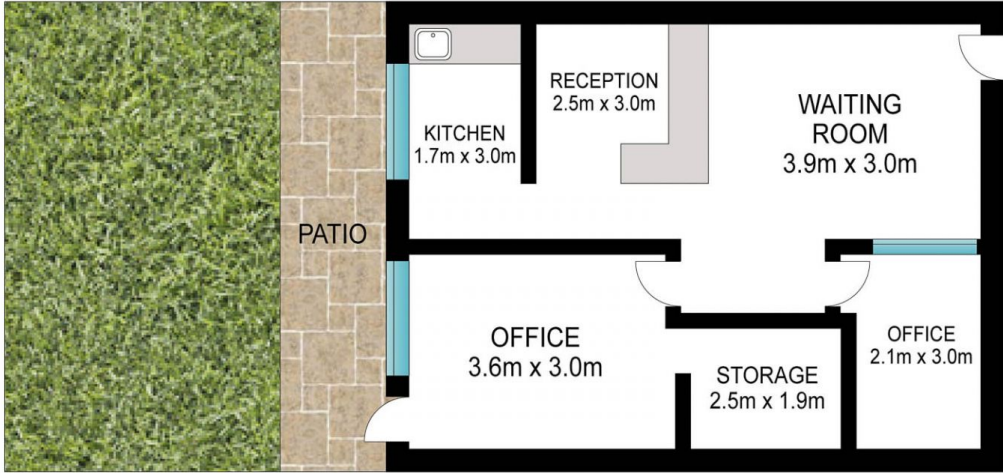

Scale in metres. Indicative only. Dimensions are approximate. All information contained herein is gathered from sources we believe to be reliable. However, we cannot guarantee its accuracy and interested persons should rely on their own enquiries.

TOTAL: 61 m²



3/26-28 Gibbs Street, Miranda